

GOLDSTAR TOOL

Cutting & Sewing Supplies

New Tech Automatic Bobbin Winder

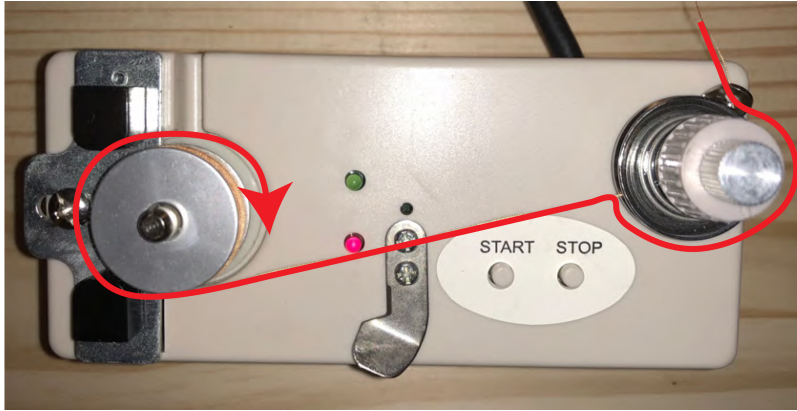

Figure 1



Scan QR Code with Your
Phone to View Video
Instructions

To load the bobbin, you will follow the path outlined in (Figure 1).

To wind the bobbin, you will need to have a thread spool holder (Figure 2).

To set the size of the bobbin you loosen the screw and slide the black or silver slider beside where you place your bobbin so arch match's edge of your bobbin (Figure 3).

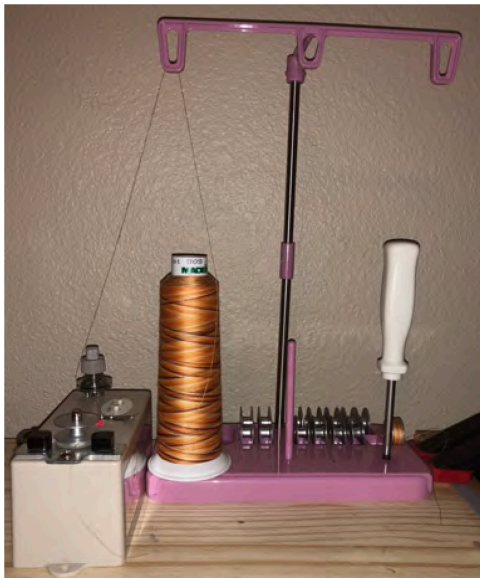

Figure 2

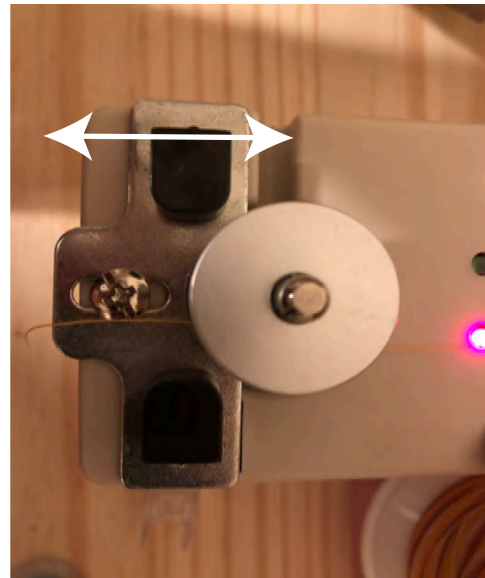

Figure 3